

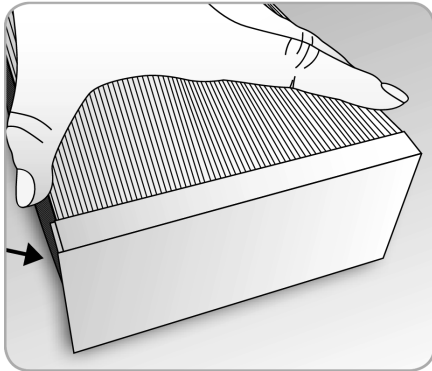

# Surface Mount **Schoolies** Installation Instructions

## Step 1

To remove the diffuser “pinch and push” the end marked with the arrow and push further into end. Pinch and push until the other end of the diffuser pops out.



## Step 2

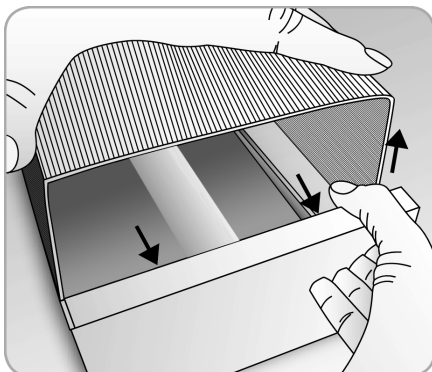

Lift up diffuser at opposite end.

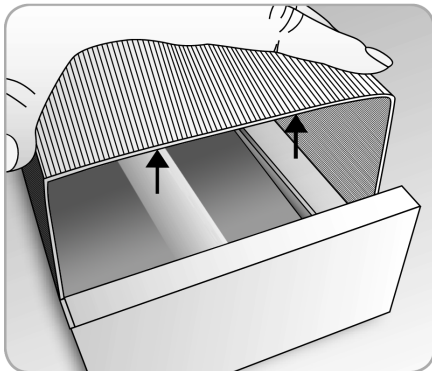

Carefully lift out diffuser.

## Step 3

Remove cover plate.

## Step 4

Secure fitting to ceiling.

## Step 5

Hard wire into terminal block.

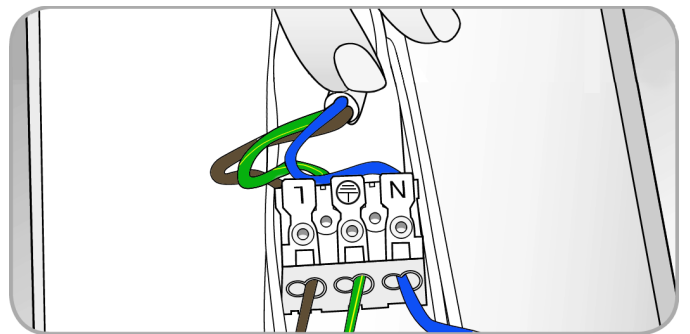

## Step 6

Secure cover plate, tuck wires under plate.

## Step 7

Pinch and push “Shotgun load”.  
Place diffuser at one end “pinch and push” to clear inside end cap lugs in the direction of arrows.

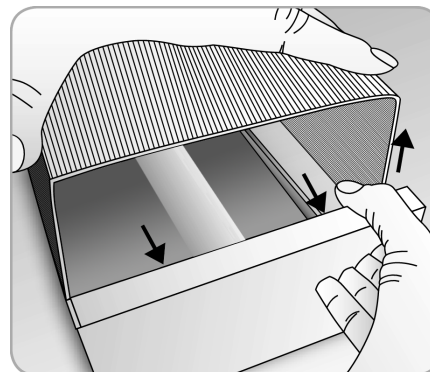

## Step 8

Once diffuser fits into other end cap gently feed diffuser along so it has a little play within both ends.

